

## SUPPORTING DOCUMENT

Licence 863320 Fora (180 Borough High Street) Objection : PUBLIC NUISANCE

Please see below a supporting document for the hearing on 4<sup>th</sup> July 2018 10:00.

The diagram below shows an approximation of residents living and sleeping areas directly above Fora, sharing a common ceiling (Fora) & floor (residents), in addition to common walls (Fora & residents).

Any existing sound insulation between residents and Fora will most likely be rendered ineffective as the effectiveness of the sound insulation being referred to will have a limit to its effectiveness and will be dependent on varying sound levels from music and up to 200 voices with varying low and high frequencies. Fora may not be able to effectively regulate the volume & high / low frequency of voices to ensure sound does not reach residents.

- **Music:** Other methods of sound & vibration transmission withstanding, lower frequencies (also known as “bass”) are likely to travel through the walls, ceiling and floor of the building (anywhere they reach), carrying with it music until the ending hours of the license. The ending hours of the license falls within the time that people tend to relax and sleep
- **Voices:** Inebriated individuals in a **restaurant & especially a bar setting** are likely to be louder than sober ones. We also believe that seated inebriated individuals, whether at a bar or table, are also generally capable of being louder than seated sober ones. The same principle of sound & vibration transmission as music applies, and dependent on the male / female mix, the varying high / low sound frequencies may travel through the building and into residents living & sleeping spaces.
- **Sleep: Noise late at night in particular** is likely to create a disturbance / public nuisance when ambient sounds are low as its significantly more noticeable alongside the quiet, not allowing residents to sleep, and there is a risk of waking residents up with sudden bursts of chatter or bass from music.
- **Relaxation: Time spent relaxing in bedroom and living areas** may be interrupted by the same disturbances.
- **The sound disturbance is likely not to be limited to apartments directly above the restaurant and bar**

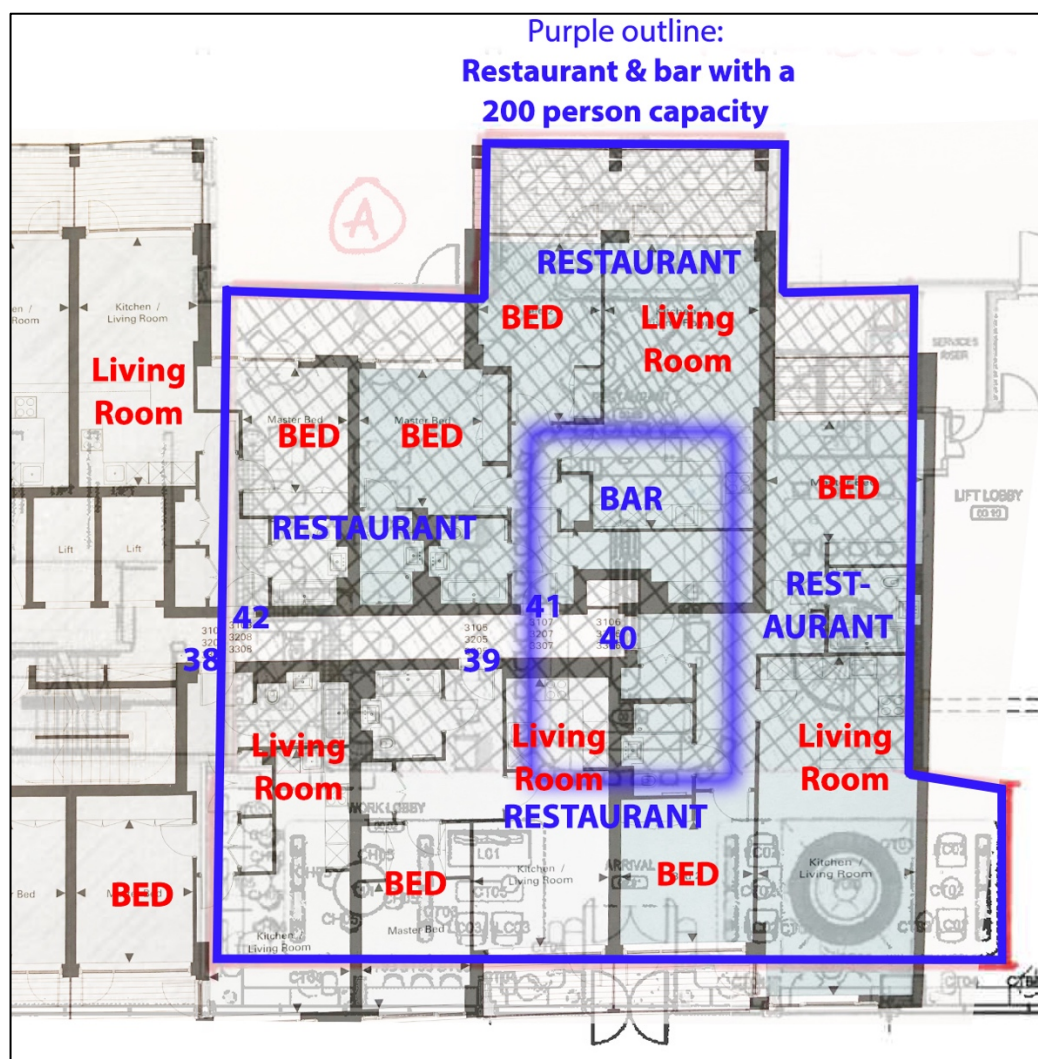

[illegible]



Brandon House Apartment plans supplied by Crest Nicholson – 1<sup>st</sup> Floor, Building 3

